

ADJUSTABLE • LIGHTWEIGHT • ADAPTABLE • EASY



The U FORM Deep Contour Back was originally designed for users with health conditions such as Kyphosis, Lordosis, and Scoliosis.

The U FORM Deep Contour Back with its superior immersion properties, has been found to provide a calming effect for users suffering from dementia or agitation causing disorders. It has also become the ideal back for comfort and protection, particularly when in a tilt or recline position.

The U FORM Deep Contour Back gives Vendors and Therapists greater flexibility to customize a product that is readily available and easy to adjust and work with.

## PRODUCT FEATURES

- Extensive adjustability for height, depth and angle of recline optimizing the users' positioning
- 2" x 2" x 2 1/2" foam cubes with 1" soft protective foam topper
- Easy access cover, with recovery, anti-bacterial, anti-microbial properties. Loop on back to hang name tag, instructions....
- Lightweight, hospital grade anodized aluminum shell
- Hardware fits 7/8" and 1" tubing and can be installed within a few minutes with the right tools.
- Quick release latch levers allow the backrest to be easily removed.
- Product Weight: 5 lbs. standard sizes 7 lbs. bariatric sizes
- Capacity: 275 lbs. (375 lbs. bariatric)

## CUSTOM CONSTRUCTION



### SEGMENTED FOAM

The segmented foam structure allows the back to be built to meet the clients unique requirements. Sections can be removed, or cut down to accommodate specific positioning needs.



### FOAM TOPPER

An additional 3/4" topper for added comfort and transition between the outer cover and the firmer segmented level.

Code	Description
------	-------------

**U FORM DEEP CONTOUR BACK • Standard Stock**

UFB1616	16" wide x 16" high
UFB1816	18" wide x 16" high
UFB2016	20" wide x 16" high

**U FORM DEEP CONTOUR BACK • Non-Stock**

UFB1618	16" wide x 18" high
UFB1620	16" wide x 20" high
UFB1716	17" wide x 16" high
UFB1720	17" wide x 20" high
UFB1818	18" wide x 18" high
UFB1820	18" wide x 20" high
UFB2018	20" wide x 18" high
UFB2020	20" wide x 20" high
CUFB	Custom Size

Code	Description
------	-------------

**U FORM DEEP CONTOUR BACK • Bariatric**

BUFB2216	22" wide x 16" high
BUFB2218	22" wide x 18" high
BUFB2220	22" wide x 20" high
BUFB2416	24" wide x 16" high
BUFB2418	24" wide x 18" high
BUFB2420	24" wide x 20" high
CBUFB	Custom size

**U FORM DEEP CONTOUR BACK • Optional Foam Structures**

MDUFS	Firm density cubed segment replacement strips, 10 cube segments per strip
LPUFS	Lateral Foam Pieces
MP15UFS	Extended Mounting Pins 1 1/2", set of 4
MP2UFS	Extended Mounting Pins 2", set of 4

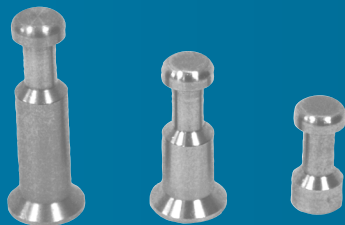

**U FORM™ EXTENSION PINS**

- Upper body smaller than lower body?
- Stainless steel extension pins allow for a narrower U Form™ Back
- to be placed in a 1" or 2" wider chair frame.